

AVANI+
Bangkok

**Welcome to
Avani+ Riverside Bangkok Hotel**

A PRIME LOCATION

Overlooking Bangkok's bustling Chao Phraya River, Avani+ Riverside Bangkok Hotel is perfectly situated to grab a bite, see the sights or head to a meeting. Shuttle boat services to the BTS Skytrain at the central Saphan Taksin boat pier make connecting to the city's major commercial, shopping and entertainment districts a breeze, but if you prefer to stick close, Riverside Plaza has 68 restaurants, bars and shops to keep you occupied.

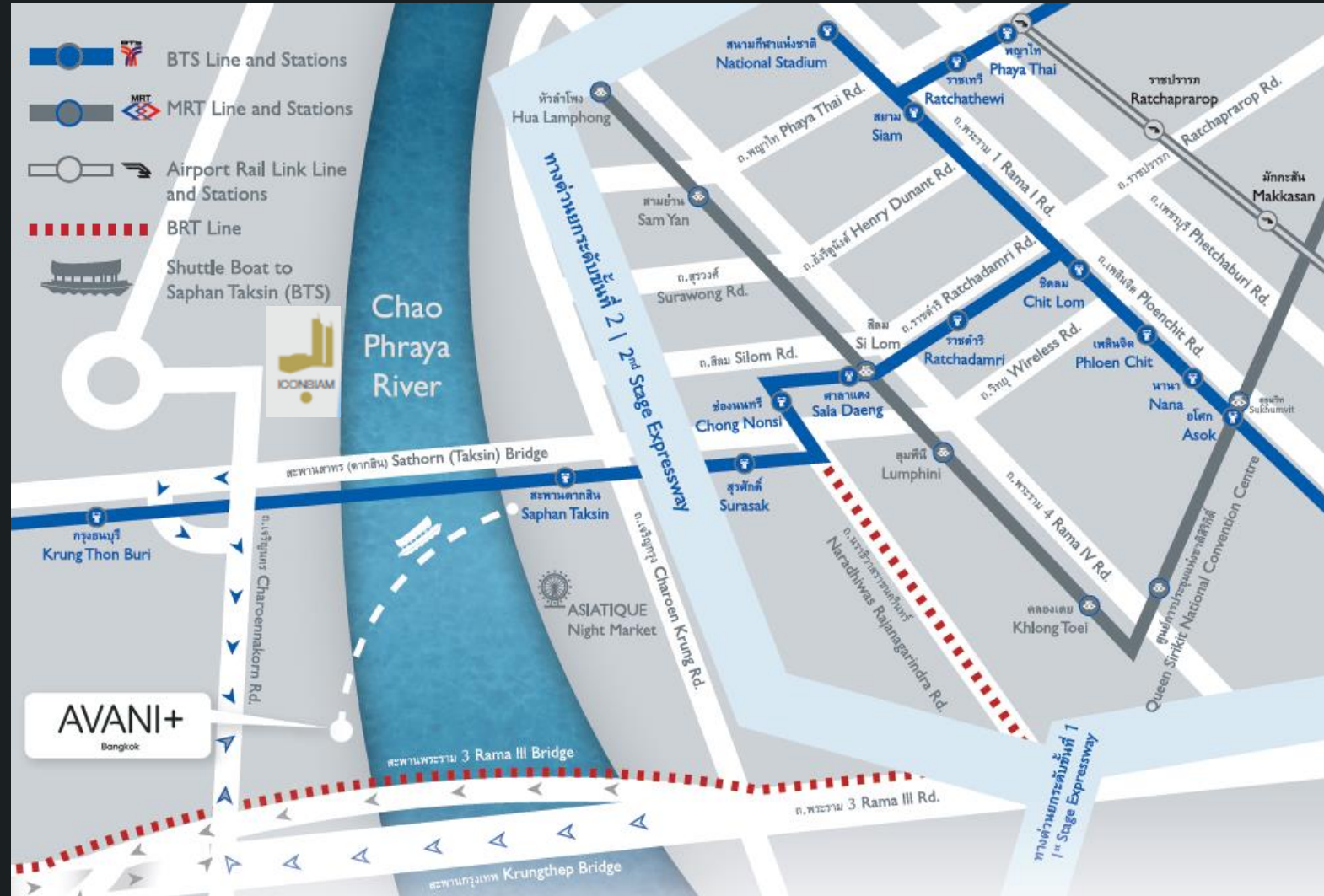



- 1 Benihana
- 2 Trader Vic's
- 3 Longtail Bar
- 4 Manohra Cruises / Anantara Cruises
- 5 Riverside Terrace
- 6 The Market
- 7 Brio
- 8 Elephant Bar
- 9 Numero Uno Café
- 10 Loy Nam Bar
- 11 Spice Spoons
- 12 Dining by Design
- 14 Lobby
- 15 Lower Lobby
- 16 Kasara Lounge
- 17 Pool
- 18 Jacuzzi
- 22 6 Fl., Tennis Courts / Muay Thai
- 23 Anantara Spa
- 24 Fitness Centre
- 25 Shuttle Boat Pier
- 26 Chang Noi Kids Club
- 27 Business Centre
- 28 Chaophraya Ballroom
- 29 Thonburi Room
- 30 Charoennakorn Room
- 31 Garden Room
- 32 Lotus Meeting Centre (Lotus, Bamboo, Jasmine, Poppy)
- 33 Grand Sala
- 34 Car Park
- 35 3 Fl., Hydroponic Farm
- 36 10 Fl., Grand Ballroom / Meeting Rooms
- 37 11 Fl., Lobby / Skyline / Longbar / PANTRY at AVANI / The Corner
- 38 25 Fl., AVANISPA / AVANIFIT
- 39 26 Fl., Infinity Pool / Infinity Bar
- 40 26 Fl., and 27 Fl., SEEN
- 41 Connecting Bridge
- 19 North Wing 301 - 330
- 20 Main Wing 331 - 362
- 21 South Wing 363 - 394
- 463 - 494
- 563 - 594
- 663 - 694
- 763 - 794

- Anantara Riverside, Ground Floor
- Anantara Riverside, Lobby Floor
- Anantara Riverside, Rooftop
- Avani+ Riverside Bangkok
- Riverside Plaza

HOTEL

Avani+ Riverside Bangkok offers 250 guest rooms including 24 suites, all on levels 12 and above and the guest lobby at Level 11; welcoming with fantastic river views, showcasing the contemporary sense of style, combined with warm and hospitable spirit.



HIGHLIGHTS

The Avani+ Riverside (250 rooms) and Anantara Riverside (376 rooms) is adjacent to each other. Combining both hotel, we have the availability of 626 guestrooms, 25 function venues and over 15 food & beverage outlets.

- Overlooking Bangkok's bustling Chao Phraya River, we are situated to get away from the hustle and bustle of the city yet within a 20 mins shuttle boat ride to the main train station
- 15 minutes (1.3 km) to ICONSIAM and Siam Takashimaya, the newly opened shopping mall on riverside
- Opposite the river to Asiatique the Riverfront, the largest night market by the river
- Along the river to Temple of Dawn (Wat Arun); Wat Pho (Temple of the Reclining Buddha); The Grand Palace (Temple of the Emerald Buddha), Lhong 1919 (19th century restored Chinese mansion)
- Approximately 45 minutes drive from Suvarnabhumi Airport
- Hop on our complimentary shuttle boat to connect to the city center (Sathorn pier)
- 248 guestrooms and suites with guaranteed river view from 12th floor and above
- 40 pairs of interconnecting rooms for families
- Reception on Level 11 with floor to ceiling windows offering magnificent river view for the great arrival experience
- AvaniClub – a flexible Executive concept
- Roof-top 25-metre infinity swimming pool on 26th floor
- SEEN, roof-top bar and restaurant on 26th and 27th floor with a breathtaking view of Chao Phraya River and Bangkok City. Great event and theme parties with our inhouse/guest DJ, Mixologist and Celebrity Chefs
- 1,152sqm with high ceiling of 11 meters (Grand Riverside Ballroom) and 7 natural daylight function venues
- Adjacent to the Riverside Plaza

AVANI RIVER VIEW ROOM (30 SQM)

75 Rooms

Avani River View Rooms offer the perfect space to relax, work and sleep in style. Stay connected with WiFi access. Make yourself comfortable with a fully stocked mini bar and take in an uninterrupted view of the River of Kings. Enjoy essential comforts at your finger tips with our IPTV system. Sink into sleep with ease and wake up feeling fresh and ready for the day ahead.



AVANI PANORAMA RIVER VIEW ROOM (30 SQM)

151 Rooms

Avani Panorama River View Rooms offer the perfect space to relax, work and sleep in style. Make yourself comfortable with a fully stocked mini bar. From high up (16th floor onwards), take in uninterrupted panoramic views over the Chao Phraya River and Bangkok's skyline. Enjoy essential convenience with our IPTV system. Sleep in stylish comfort and re-energise for a fresh new day.



AVANI RIVER VIEW JUNIOR SUITE (62 SQM)

20 Suites

Avani River View Junior Suites spoil you with generous space and contemporary comforts. The fresh crisp white bathroom flows into a delightful well-appointed bedroom. Keep in touch with WiFi and allow our IPTV system to take care of your every need. Soak in panoramic river views through wide windows from your bedroom or as you soak the day away in a full size tub.



AVANI RIVER VIEW TWO BEDROOM SUITE (138 SQM)

2 Suites

Families and friends have plenty of space to stay and play in our two-bedroom, two-bath suites. Separate living and dining spaces, plus a kitchen and wet bar, mean that everyone can stretch out in style and enjoy WiFi, mini bar snacks, added comforts from the IPTV system and the endless views of the river.



AVANI RIVER VIEW THREE BEDROOM SUITE (166 SQM)

1 Suite

With modern style and exceptional amenities amongst suites in Bangkok, the Avani River View three-bedroom, three-bath suite was designed with you in mind. Stay plugged in with WiFi and enjoy the benefits of the IPTV system. Sink into the bathtub to relax and unwind. Sneak into the full kitchen and wet bar for a midnight snack, or just nibble from the mini bar.



AVANI CLUB - A FLEXIBLE EXECUTIVE CONCEPT

You can enjoy all the benefits of a lounge programme, without visiting a lounge. Simply 'grab & go', top up your mini bar, grab freshly prepared breakfast for a busy day, make plans for the next day over cocktails at The Corner.

AvaniClub Includes:

- iPad check-in including welcome drink at AvaniClub
- Artisanal breakfast with take-away items
- All day access to The Pantry, including complimentary coffee, tea, fresh juices & soft drinks
- In-room basket for topping up your own mini-bar from The Pantry
- The Social Corner - house selection, cocktails, canapés every evening from 5:30 pm - 7:30 pm at The Corner

THB 1,000++ per adult per day

THB 500++ for children aged between 6-12 years old

AVANI+
Bangkok



WINE & DINE



AVANI+

Bangkok

SEEN RESTAURANT & BAR BANGKOK, 26th FLOOR ATTITUDE BAR at SEEN, 27th FLOOR

Opening Hours 6:00 pm – 1:00 am

A multi-storey, multi-sensory playground overlooking the city skyline and Chao Phraya river. A modern Portuguese-Brazilian menu from celebrity chef Olivier da Costa is cooked to perfection and served up by Chef de Cuisine Alexandre Castaldi. Head to the lounge, deck or stunning rooftop for sensual beats by Music Director Scotty B and worldly cocktails by our Mixologists.



SEEN RESTAURANT & BAR BANGKOK, 26th and 27th FLOOR
Capacity Chart

	DIMENSION (WxLxH)	SIT DOWN DINNER	STANDING COCKTAIL WITH TABLE	STANDING COCKTAIL WITHOUT TABLE
THE ROOM	10x12x4.8 m.	60 guests	60 guests	80 guests
THE BAR (BACK BAR)	10x8x4.8 m.	15 guests	15 guests	40 guests
THE BAR (FRONT BAR)	10x13.5x4.8 m.	50 guests	50 guests	80 guests
THE GARDEN	7x12x9 m.	70 guests	70 guests	120 guests
26TH FLOOR	37x45.5x4.8 m.	180 guests	180 guests	350 guests
THE VIEW	10x21x10 m.	-	60 guests	180 - 200 guests

SKYLINE, 11th FLOOR

Opening hours daily from 6:00 am – 10:00 pm

Savour sunrise and sunset with uninterrupted views of the Chao Phraya River at Skyline, our all day dining restaurant. Serves an international breakfast and dinner buffet filled with local specialties. Craving something specific? A la carte treats are also available.



LONG BAR, 11th FLOOR

Opening hours daily from 11:00 am – 11:00 pm

A selection of snacks and delightful afternoon tea is served at the modern and welcoming lobby bar, offering the perfect spot to connect with friends or unwind after a long day.



PANTRY AT AVANI, 11th FLOOR

Open 24 hours

A selection of snacks and delightful afternoon tea is served at the modern and welcoming lobby bar, offering the perfect spot to connect with friends or unwind after a long day.









MEETING EVENT WEDDING



AVANI+
Bangkok

CAPACITY CHART

Names	Area		Dimensions (W x L x H)		Seating Options						
	M ²	F ²	M.	Ft.	Theatre	Classroom	U-Shape	Boardroom	Banquet	Cocktail	H-square
											
Grand Riverside Ballroom	1152	12400	40 x 29 x 11	131 x 95 x 36	972	720	135		720	1200	174
- Lunar	385	4144	13.3 x 29 x 11	44 x 95 x 36	300	195	81		210	300	96
- Moon	385	4144	13.3 x 29 x 11	44 x 95 x 36	300	195	81		210	300	96
- Galaxy	385	4144	13.3 x 29 x 11	44 x 95 x 36	300	195	81		210	300	96
• Galaxy 1	190	2050	13.3 x 14 x 11	44 x 47 x 36	120	75	39		90	150	54
• Galaxy 2	190	2050	13.3 x 14 x 11	44 x 47 x 36	120	75	39	36	90	150	54
Wind	140	1507	8 x 18 x 4	26 x 58 x 13	120	72	33	36	80	100	36
Sky	175	1883	8 x 22 x 4	26 x 72 x 13	120	72	39	42	80	100	39
Air	220	2368	10 x 23 x 4	32 x 75 x 13	192	114	51	24	120	180	60
- Air 1	65	699	7 x 9 x 4	23 x 30 x 13	40	30	21	24	20	40	24
- Air 2	80	861	10 x 10 x 4	26 x 33 x 13	60	48	21	18	40	60	30
- Air 3	60	645	6 x 11 x 4	18 x 37 x 13	40	27	18	12	20	50	24
Horizon	90	990	8 x 12 x 4	26 x 38 x 13	30	18	15	12	20	30	18
Breeze	90	990	8 x 12 x 4	26 x 38 x 13	30	18	15	12	20	30	18

Pre Function Areas	Area		Seating Options (Cocktail)
	M.	F ²	
Ozone 1	434	4672	800
Ozone 2	391	4209	400
Ozone 3	200	2152	400
The Terrace	120	1290	-

Additional Services	Area	
	M.	F ²
The Theatre	150	1586
Business Centre	50	538
Juno Suite	40	430

AVANI+

Bangkok

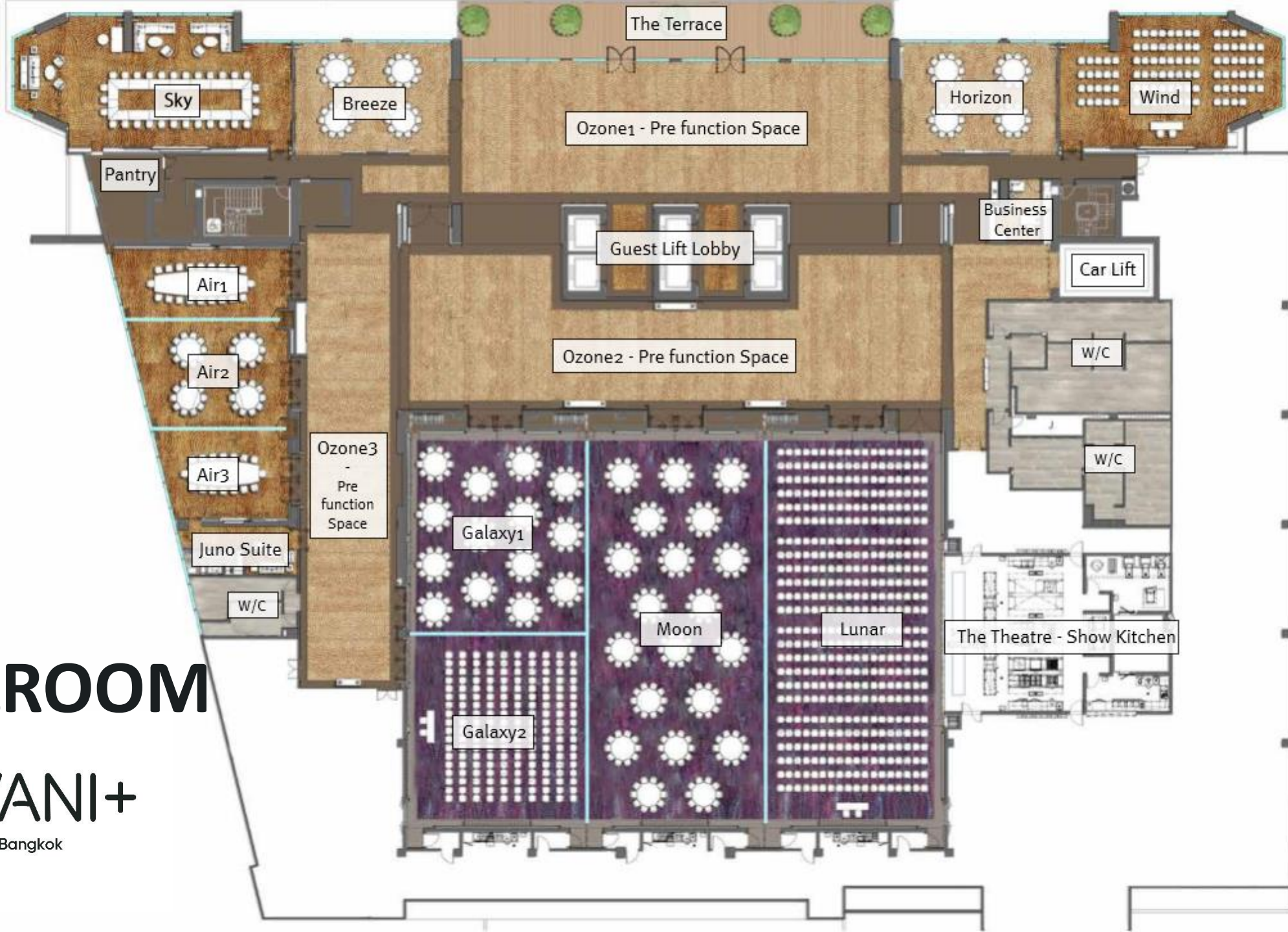

BALLROOM

AVANI+

Bangkok

MEETING ROOMS



AVANI+
Bangkok

MEETING ROOMS



AVANI+
Bangkok

THANK YOU

